

PREPARED FOR:
SHERRY DIXON
COLDWELL BANKERS PRIMUS
226 BROAD STREET
LAKE GENEVA WI
53147

PLAT OF SURVEY

KROTT SURVEYING INC.
N3705 WILLOW BEND LANE
LAKE GENEVA WI. 53147
PHONE # (262)248-3697
FAX # (262)249-0639

-OF-
LOT 4, BLOCK 3, ALLYNHURST A SUUBDIVISION, LOCATED IN THE SE 1/4 OF
THE SW 1/4 AND IN THE SW 1/4 OF THE SW 1/4 OF SECTION 17 AND IN THE
NW 1/4 OF THE NW 1/4 AND IN THE NE 1/4 OF THE NW 1/4 OF SECTION 20,
T.2.N. , R.16.E. , CITY OF DELAVAN , WALWORTH COUNTY , WISCONSIN.

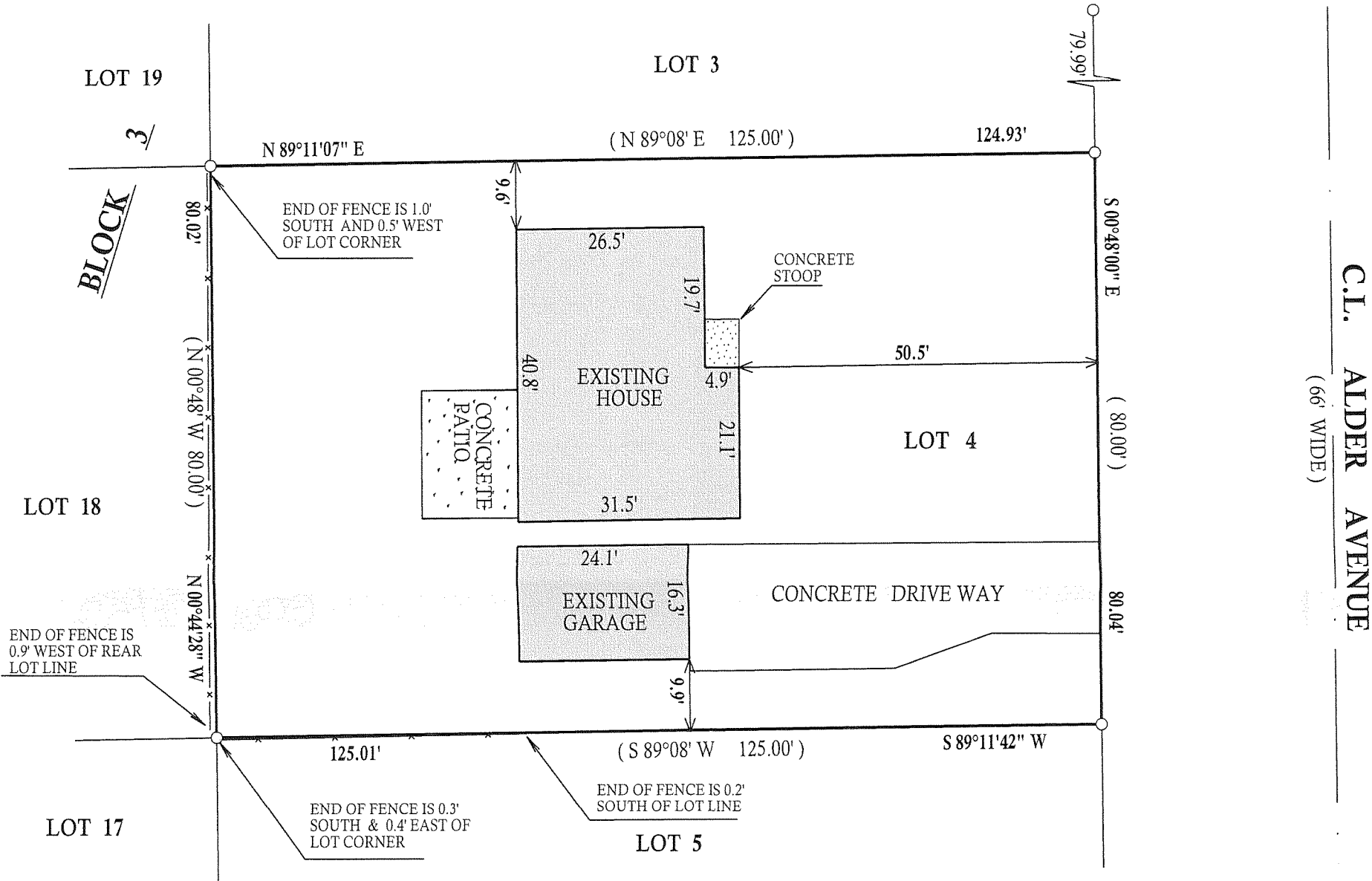

DEC - 1 2008

8MK

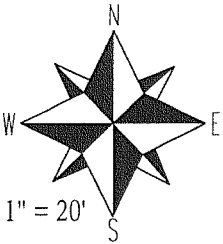

SCALE 1" = 20'

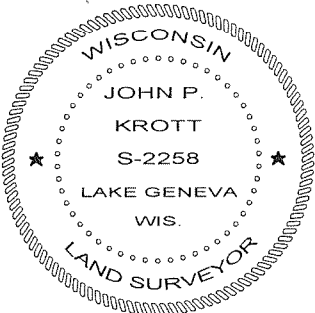

LEGEND

○ FOUND IRON PIPE

(xx) RECORDED AS

JOB # 08-203

TAX ID # XAS00023

"I hereby certify that I have surveyed the above described property and that the above map is a true representation thereof and shows the size and location of all visible structures, apparent easements and encroachments if any."

This survey is made for the present owners of the property, and those who purchase, mortgage, or guarantee the title thereto, within one year from the date hereof.

DATED THIS THE 15th DAY OF SEPTEMBER, 2008.

John P. Krott

JOHN KROTT S - 2258
Wisconsin Registered Land Surveyor
(original if signed in red)

XAS-23

002-2452